



115 Crossway

Plympton, Plymouth, PL7 4HZ

£280,000



Offered with no onward chain is this extended, semi-detached Stanbury-built family home located in the Woodford area of Plympton. The accommodation briefly comprises a large front porch & entrance hallway, lounge, dining room, kitchen & rear porch with a cloakroom. Upstairs there are 3 good-sized bedrooms & a 4-piece family bathroom. Externally the property benefits from a hardstand, a garage with a small workshop, a shared driveway & gardens.



CROSSWAY, PLYMPTON, PLYMOUTH PL7 4HZ

ACCOMMODATION

uPVC double-glazed door, with inset obscured glass panels, opening into the entrance porch.

ENTRANCE PORCH 9'10" x 6'1" (3.02 x 1.87)

Wooden door, with inset obscured glass and uPVC double-glazed windows to all sides, opening into the entrance hallway.

ENTRANCE HALLWAY 10'7" x 5'11" (3.25 x 1.82)

Doors leading to the lounge and kitchen. Stairs ascending to the first floor accommodation with storage cupboards beneath. uPVC double-glazed window to the side elevation.

LOUNGE 14'2" max x 12'4" (4.32 max x 3.77)

Gas fireplace set onto a stone hearth with a stone surround. uPVC double-glazed bay window to the front elevation. Door opening to the dining room.

DINING ROOM 21'7" x 10'9" (6.59 x 3.29)

Built-in bureau. uPVC double-glazed window to the rear elevation. Door leading to the kitchen.

KITCHEN 12'7" x 7'4" max (3.85 x 2.25 max)

Matching range of base and wall-mounted units incorporating a roll-edged laminate worktop with an inset stainless-steel sink unit. Spaces for a fridge/freezer, washing machine, dishwasher and oven. uPVC double-glazed window to the side elevation. Built-in larder cupboard with an obscured uPVC double-glazed window to the side elevation. Door leading the rear porch.

REAR PORCH 5'4" x 3'7" (1.64 x 1.11)

Sliding door opening to the downstairs cloakroom. uPVC double-glazed door, with inset obscured glass, opening to the rear garden. Hatch providing access to a small loft.

DOWNSTAIRS CLOAKROOM 5'4" x 2'7" (1.65 x 0.79)

Close-coupled wc and a wall-mounted sink. Wall-mounted boiler. Obscured uPVC double-glazed window to the rear elevation.

FIRST FLOOR LANDING 8'0" x 7'0" (2.45 x 2.14)

Doors providing access to the first floor accommodation. Hatch with pull-down ladder providing access to the boarded, insulated loft space with power and lighting. uPVC double-glazed window to the side elevation.

BEDROOM ONE 13'6" x 9'6" (4.14 x 2.90)

Built-in wardrobes. uPVC double-glazed window to the front elevation.

BEDROOM TWO 12'8" x 11'2" max (3.88 x 3.42 max)

Built-in wardrobes with a vanity station. Built-in cupboard. uPVC double-glazed window to the rear elevation.

BEDROOM THREE 9'10" x 7'0" (3.00 x 2.14)

uPVC double-glazed window to the front elevation.

BATHROOM 8'0" x 6'10" (2.44 x 2.10)

Square shower cubicle with a mains-fed shower, matching panel bath with a shower attachment, pedestal wash handbasin and close-coupled wc. Obscured uPVC double-glazed windows to the side elevation.

OUTSIDE

The property is approached via a brick-paved hard-stand, with bordering flowerbeds and bushes and steps leading up to the front porch. Down the side of the house there is a shared driveway leading to the garage. From the driveway a metal gate opens to the rear garden which includes a patio area and an area laid to stone chippings, bordered by mature trees and bushes.

DETACHED GARAGE 15'11" x 7'11" (4.87 x 2.43)

Up-&-over door. Power and lighting. Door to the rear leading to a workshop.

WORKSHOP 10'0" x 6'3" (3.06 x 1.91)

Fitted work bench. Wall-mounted storage cabinets. Aluminium double-glazed door with obscured glass leading to the garden.

COUNCIL TAX

Plymouth City Council
Council Tax Band: C

SERVICES

The property is connected to all the mains services: gas, electricity, water and drainage.

WHAT3WORDS

///panels.issue.calm

Area Map



Floor Plans

GROUND FLOOR



1ST FLOOR

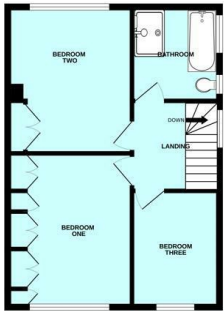

Energy Efficiency Graph

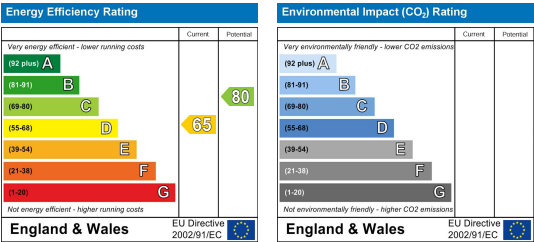

These particulars, whilst believed to be accurate are set out as a general outline only for guidance and do not constitute any part of an offer or contract. Intending purchasers should not rely on them as statements of representation of fact, but must satisfy themselves by inspection or otherwise as to their accuracy. No person in this firms employment has the authority to make or give any representation or warranty in respect of the property.